

BS2304 / BS2304C

Bar Stool Assembly Instructions

Max Weight Capacity 330 Lb

201307

READ ALL INSTRUCTIONS AND WARNINGS BEFORE USING THIS PRODUCT.

This manual provides important information on proper operation & maintenance. Every effort has been made to ensure the accuracy of this manual. These instructions are not meant to cover every possible condition and situation that may occur. We reserve the right to change this product at any time without prior notice.

IF THERE IS ANY QUESTION ABOUT A CONDITION BEING SAFE OR UNSAFE,
DO NOT USE THIS PRODUCT!

DO NOT RETURN THIS PRODUCT TO THE RETAILER - CONTACT CUSTOMER SERVICE.

If you experience a problem, have questions or need parts for this product, visit our website <http://www.amerihomebrand.com> or call Customer Service at 1-888-287-6981, **Monday-Friday, 8 AM - 4 PM Central Time**. A copy of the sales receipt is required.

KEEP THIS MANUAL, SALES RECEIPT & APPLICABLE WARRANTY FOR FUTURE REFERENCE.

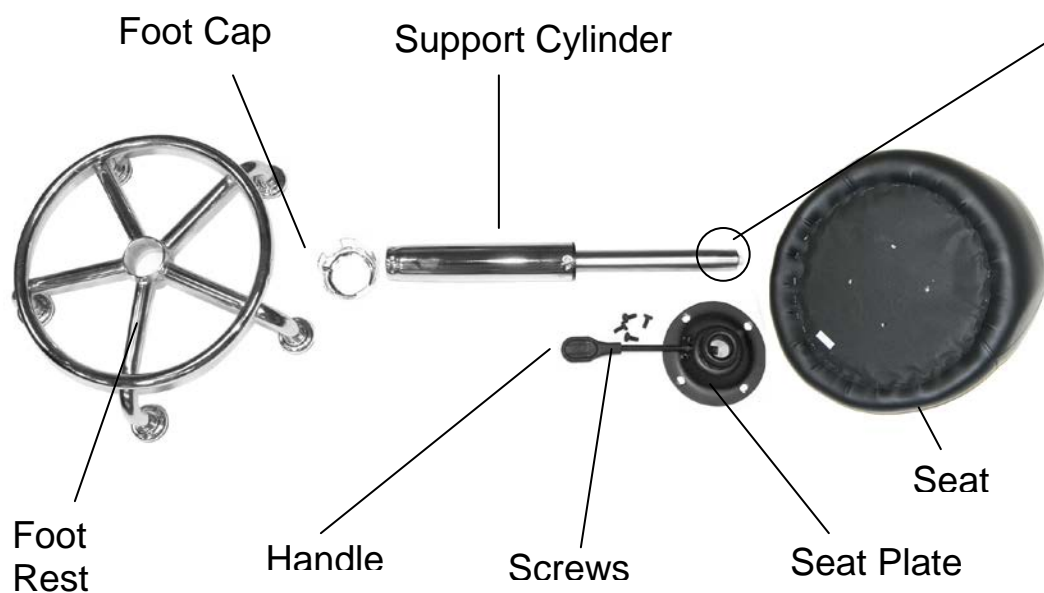

ATTENTION!

Remove Black Cap

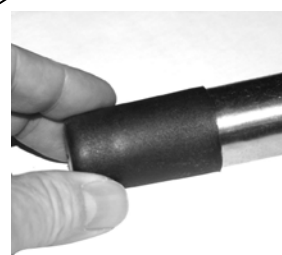

Discard Before Assembly

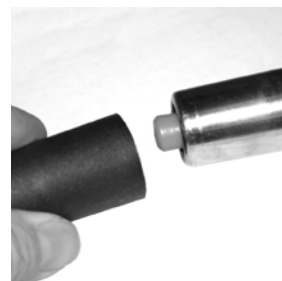

ASSEMBLY INSTRUCTION

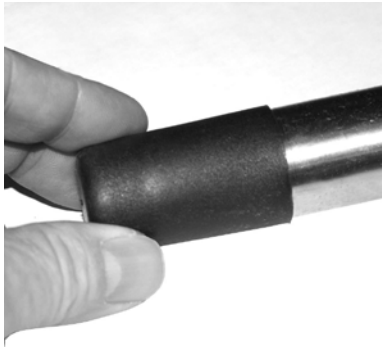

A Black Cap protects the hydraulic mechanism on the Support Cylinder.

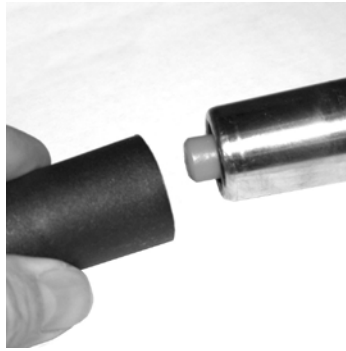

Remove the Black Cap and discard it before assembly. The Orange hydraulic button will become visible.



Use an allen wrench to attach the Seat Plate to the underside of the Seat with the provided Screws.



Insert the Support Cylinder into the center of the Seat Plate



Place the Foot Cap over the Footrest.



Insert the Support Cylinder into the center hole of the Footrest



Press down firmly on seat to secure into base.

To raise and lower the Seat, grasp the Handle and pull upward without applying any weight on the Seat. To lower, raise the Handle upward by sitting on the Seat.



To disassemble, turn the stool upside down, and hit the metal clip on the center of the bottom of the Footrest with a rubber mallet to disengage the locking mechanism. Then, turn the stool right side up, and lift the Seat upward, pulling the Seat Assembly off of the Footrest.



Metal Clip

To separate the Support Cylinder from the Seat, gently strike the Seat Plate with a rubber mallet until the Seat and Support Cylinder have separated.

MODEL B2304C ROLLING CASTER WHEEL ASSEMBLY

If you have Model B2304C, remove the Stationary Feet by unscrewing each one, and replace them with the Caster Wheels.

